

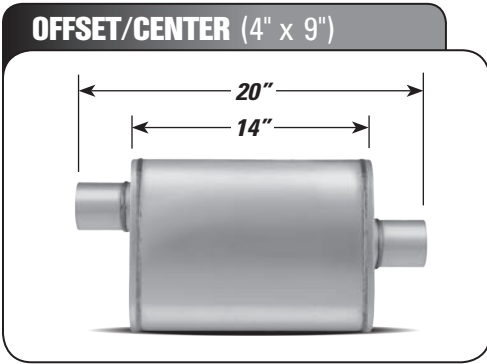

PERFORMANCE MUFFLERS

HIGH PERFORMANCE STAINLESS STEEL



P/N	INLET	OUTLET
XS1224	2"	2"
XS1225	2 ¼"	2 ¼"
XS1226	2 ½"	2 ½"
XS1229	3"	3"

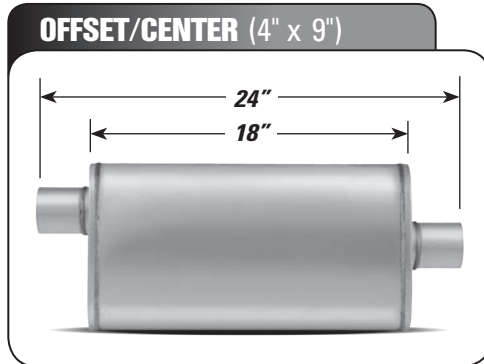

P/N	INLET	OUTLET
XS1255	2 ¼"	2 ¼"
XS1256	2 ½"	2 ½"
XS1259	3"	3"

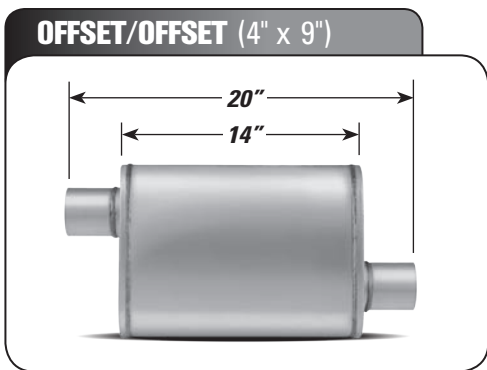

P/N	INLET	OUTLET
XS1235	2 ¼"	2 ¼"
XS1236	2 ½"	2 ½"

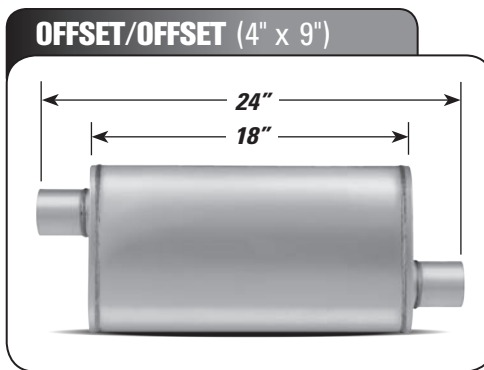

P/N	INLET	OUTLET
XS1266	2 ½"	2 ½"

PERFORMANCE FEATURES

- Heavy gauge 100% Stainless Steel
- All welded construction
- Straight through flow design
- Increase flow
- Excellent performance sound
- Reversible
- High temperature acoustical filler material
- Better performance



**4" x 9" OVAL
REVERSIBLE**

TRANSVERSE & OFFSET/DUALS (4" x 9")

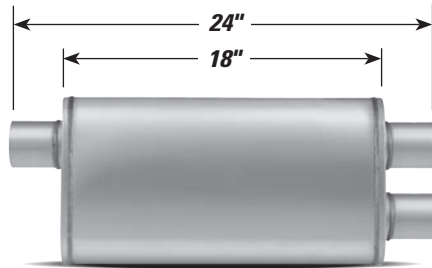

P/N	INLET	OUTLET
XS2265	2 ½"	2 ½"

CENTER/DUALS (4" x 9")

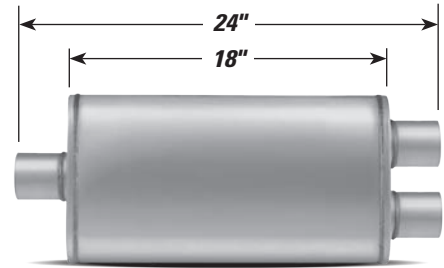

P/N	INLET	OUTLET
XS2258	2 ½"	2 ¼"
XS2268	2 ½"	2 ½"
XS2278	3"	2 ¼"
XS2288	3"	2 ½"
XS2298	3"	3"



CENTER/DUALS (4" x 9")

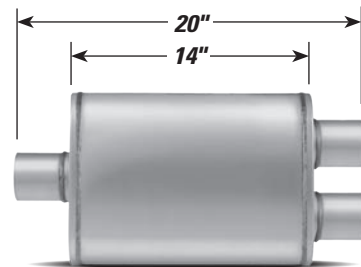

P/N	INLET	OUTLET
XS1149	2 ¼"	2 ¼"
XS2157	2 ½"	2 ¼"
XS2158	2 ½"	2 ½"
XS2198	3"	2 ½"

HIGH PERFORMANCE STAINLESS STEEL

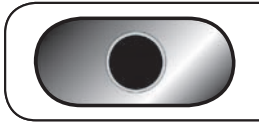

**5" x 11" LARGE OVAL
REVERSIBLE**

CENTER/CENTER (5" x 11")

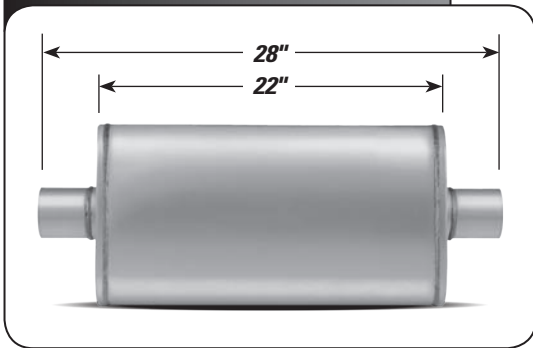

P/N	INLET	OUTLET
XS2579	3"	3"

DUALS/CENTER OR CENTER/DUALS (5" x 11")

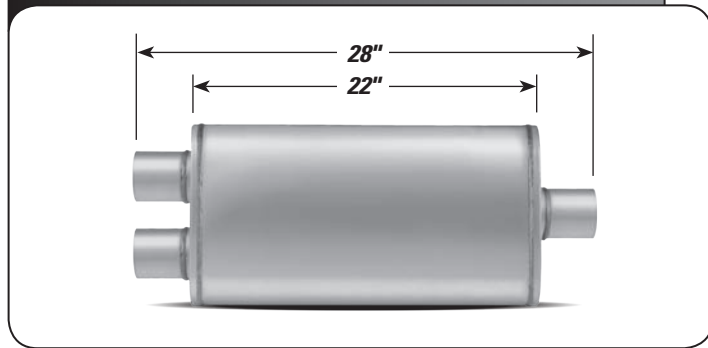

DUALS/CENTER

P/N	INLET	OUTLET
XS2588	2 1/2"	3"

CENTER/DUALS

P/N	INLET	OUTLET
XS2588	3"	2 1/2"

CENTER/OFFSET (5" x 11")

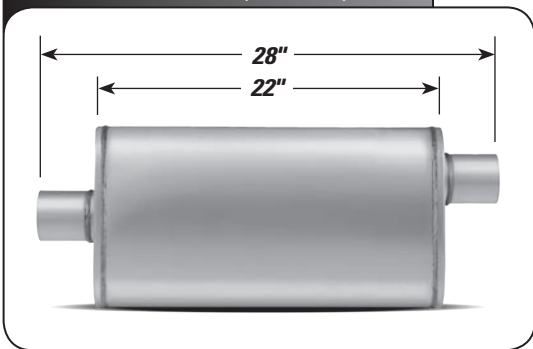

P/N	INLET	OUTLET
XS2589	3"	3"

DUALS/DUALS (5" x 11")

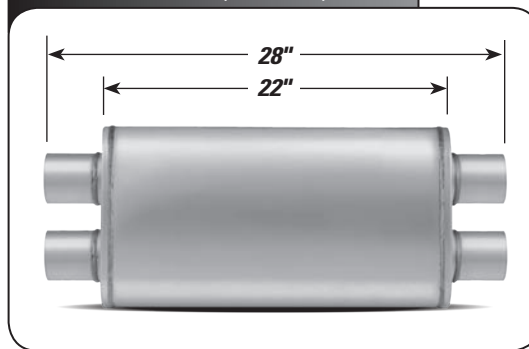

P/N	INLET	OUTLET
XS2568	2 1/2"	2 1/2"

PERFORMANCE FEATURES

- Heavy gauge 100% Stainless Steel
- All welded construction
- Straight through flow design
- Increase flow
- Excellent performance sound
- Reversible
- High temperature acoustical filler material
- Better performance



4" ROUND REVERSIBLE

CENTER/CENTER (4" Round)

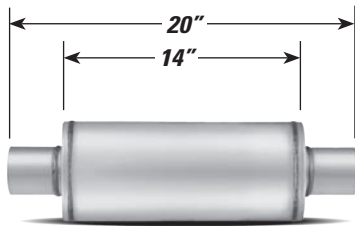

P/N	INLET	OUTLET
XS0445	2 ¼"	2 ¼"
XS0416	2 ½"	2 ½"

CENTER/CENTER (4" Round)

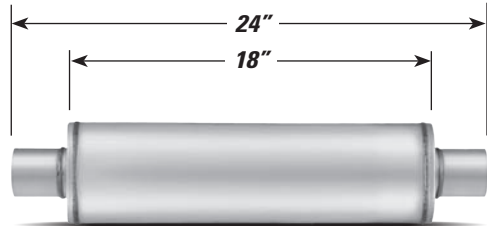

P/N	INLET	OUTLET
XS0425	2 ¼"	2 ¼"
XS0426	2 ½"	2 ½"

CENTER/CENTER (7" Round)

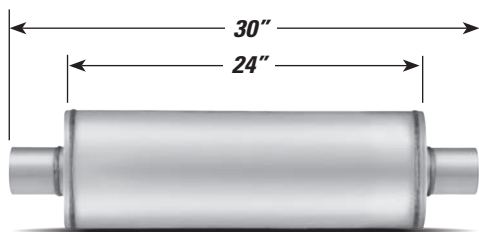

P/N	INLET	OUTLET
XS2772	4"	4"



VX SERIES HIGH PERFORMANCE MUFFLERS

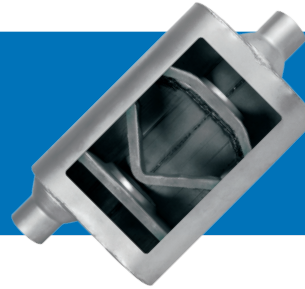

4 1/4" x 9 1/2" OVAL

CENTER/OFFSET (4 1/4" x 9 1/2")

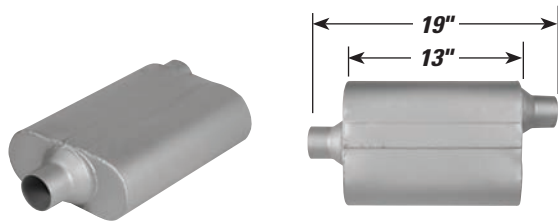

OFFSET/CENTER (4 1/4" x 9 1/2")

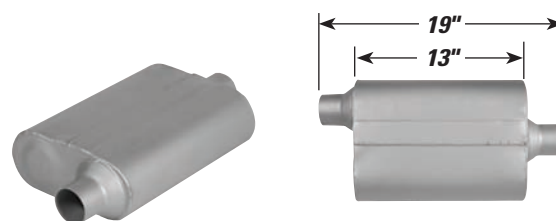

P/N	Inlet	Outlet
VX2442	2 1/4"	2 1/4"
VX2542	2 1/2"	2 1/2"
VX3042	3"	3"

P/N	Inlet	Outlet
VX2441	2 1/4"	2 1/4"
VX2541	2 1/2"	2 1/2"
VX3041	3"	3"

OFFSET/OFFSET (4 1/4" x 9 1/2")

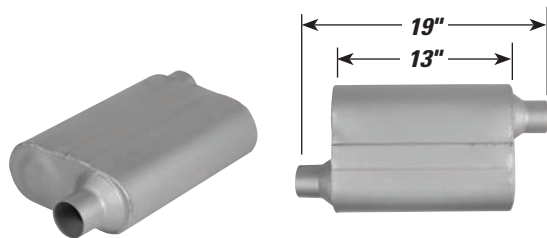

CENTER/DUALS (4 1/4" x 9 1/2")

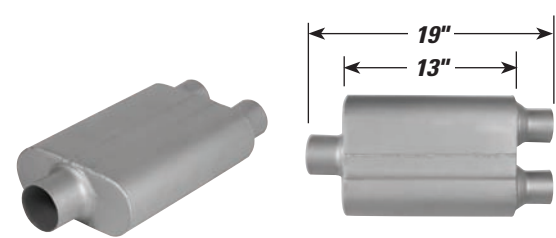

P/N	Inlet	Outlet
VX2443	2 1/4"	2 1/4"
VX2543	2 1/2"	2 1/2"
VX3043	3"	3"

P/N	Inlet	Outlet
VX0402	3"	2 1/2" Duals
VX0422	3"	2 1/4" Duals
VX4422	2 1/4"	2 1/4" Duals
VX5400	2 1/2"	2 1/2" Duals
VX5422	2 1/2"	2 1/4" Duals

PERFORMANCE FEATURES

- 100% Aluminized
- V-FLOW for deep, aggressive sound
- Better performance
- Increase flow

DUALS/DUALS (4 ¼" x 9 ½")

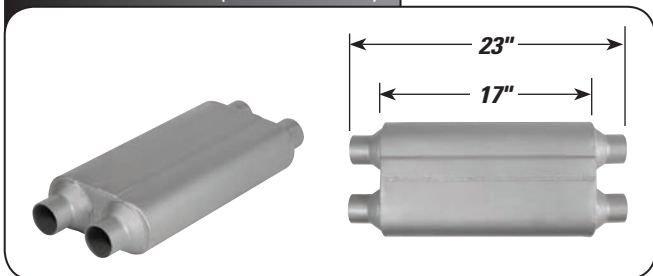

P/N	Inlet	Outlet
VX4554	2 ¼" Duals	2 ¼" Duals

TRANSVERSE (4 ¼" x 9 ½")

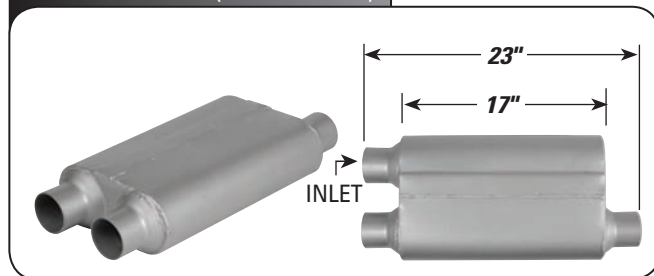

P/N	Inlet	Outlet
VX2583	2 ½"	2 ½"

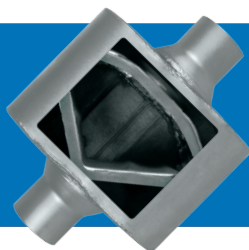

VR SERIES RACE PERFORMANCE MUFFLERS

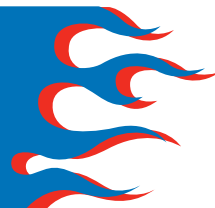

CENTER/CENTER (4 ¼" x 9 ½")

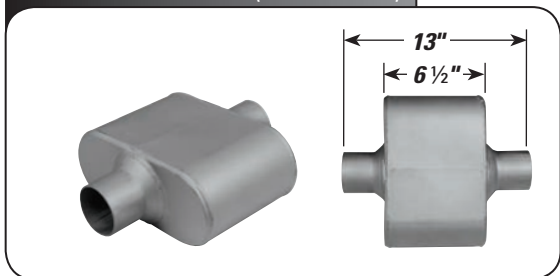

P/N	Inlet	Outlet
VR7426	2 ½"	2 ½"
VR7428	3"	3"

CENTER/DUALS (4 ¼" x 9 ½")

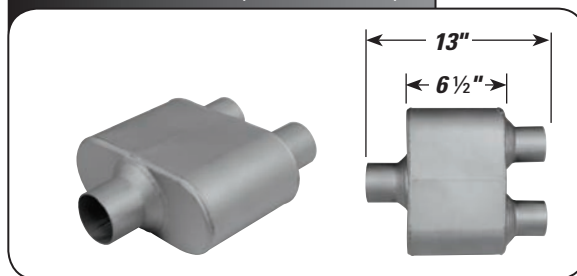

P/N	Inlet	Outlet
VR7425	2 ½"	2 ¼" Duals
VR7427	3"	2 ½" Duals

OFFSET/OFFSET (4 ¼" x 9 ½")

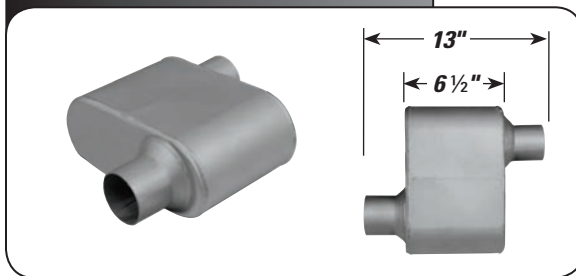

P/N	Inlet	Outlet
VR7429	2 ¼"	2 ¼"
VR7430	2 ½"	2 ½"

BIG MAX® PERFORMANCE TURBO



3 1/4" x 7 3/4"
SMALL OVAL

OFFSET/CENTER (3 1/4" x 7 3/4")

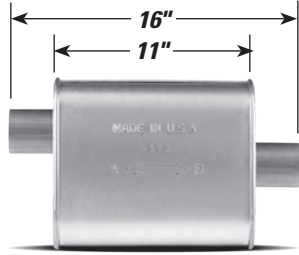

P/N	INLET	OUTLET
690008	2"	2"

OFFSET/OFFSET (3 1/4" x 7 3/4")

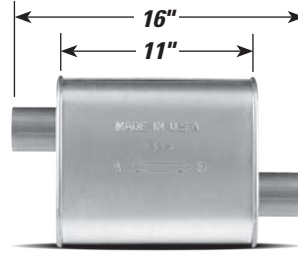

P/N	INLET	OUTLET
690003	2"	2"

OFFSET/CENTER (3 1/4" x 7 3/4")

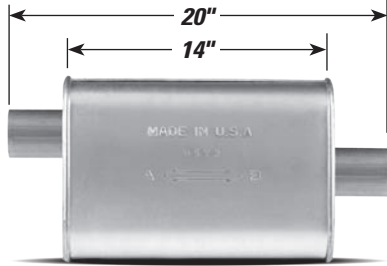

P/N	INLET	OUTLET
6519	2"	2"

OFFSET/OFFSET (3 1/4" x 7 3/4")



P/N	INLET	OUTLET
6495	2"	2"



4 1/4" x 8 3/4"
MEDIUM OVAL

CENTER/CENTER (4 1/4" x 8 3/4")



P/N	INLET	OUTLET
6492	2 1/4"	2 1/4"

OFFSET/OFFSET (4 1/4" x 8 3/4")

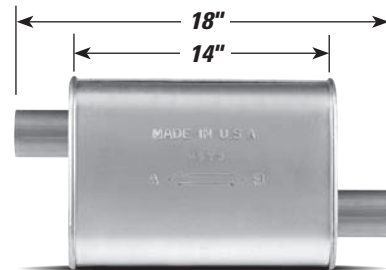

P/N	INLET	OUTLET
6497	2"	2"
6498	2 1/4"	2 1/4"
6499	2 1/2"	2 1/2"

PERFORMANCE FEATURES

- 100% Aluminized
- Better performance
- AKDDQ expandable necks
- Reduced backpressure
- Increase flow
- Excellent performance sound
- Large inner tubes
- Reversible Designs

OFFSET/CENTER (4 ¼" x 8 ¾")



P/N	INLET	OUTLET
6496	2"	2"
6534	2 ¼"	2 ¼"
6494+	2 ½"	2 ½"

+ Replaces 2940

OFFSET/CENTER (4 ¼" x 8 ¾")

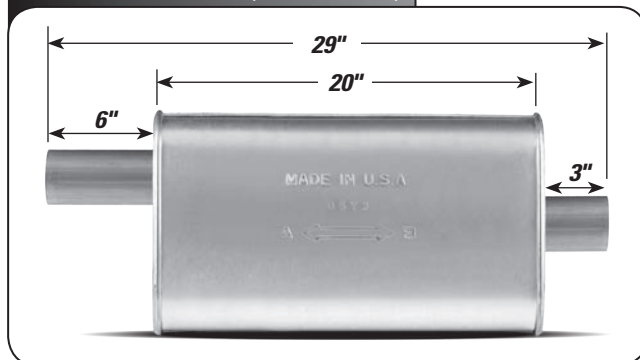

P/N	INLET	OUTLET
6491	2 ¼"	2 ¼"



OFFSET/CENTER (4 ¼" x 10 ½")

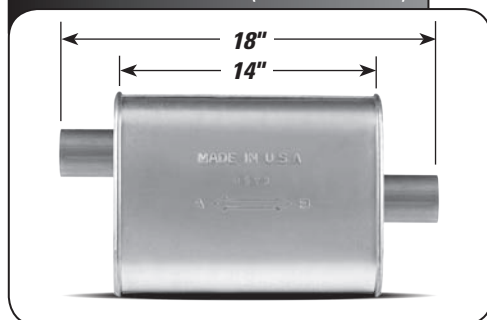

P/N	INLET	OUTLET
690501	2"	2"
690500	2 ¼"	2 ¼"
690503	2 ½"	2 ½"

OFFSET/CENTER (4 ¼" x 10 ½")



P/N	INLET	OUTLET
6493+	2 ¼"	2 ¼"

+ Replaces 2973. Hemi muffler w/ crushed corners

BIG MAX® PERFORMANCE TURBO

OFFSET/CENTER (4 1/16" x 10 1/2")

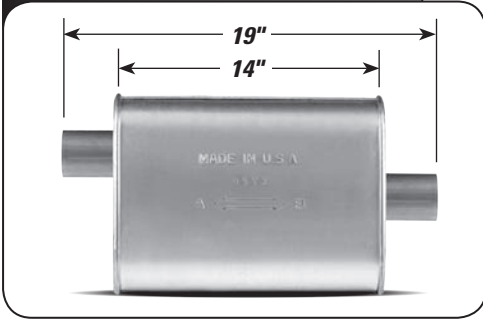

P/N	INLET	OUTLET
690502	3"	3"

CENTER/DUALS (4 1/16" x 10 1/2")

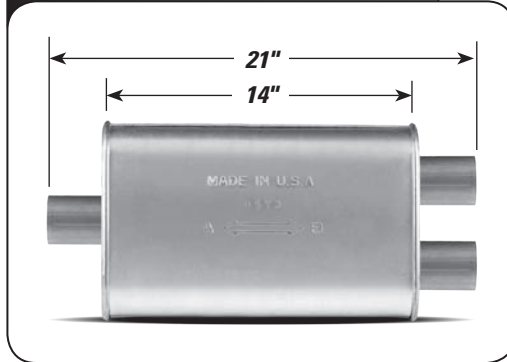

P/N	INLET	OUTLET
690513	2 1/2"	2 1/4"
690514	2 1/2"	2 1/2"
690510	3"	2 1/4"
690511	3"	2 1/2"



CENTER/DUALS (4 1/2" x 11")



P/N	INLET	OUTLET
690512	3"	3"

CHEVROLET/GMC MUFFLERS

1500, 2500, 3500 HeavyDuty 6.0 & 8.1 Litre Gas Engines



DUAL OUTLETS FIT OEM TAIL PIPE (8 1/2" x 11 3/4")

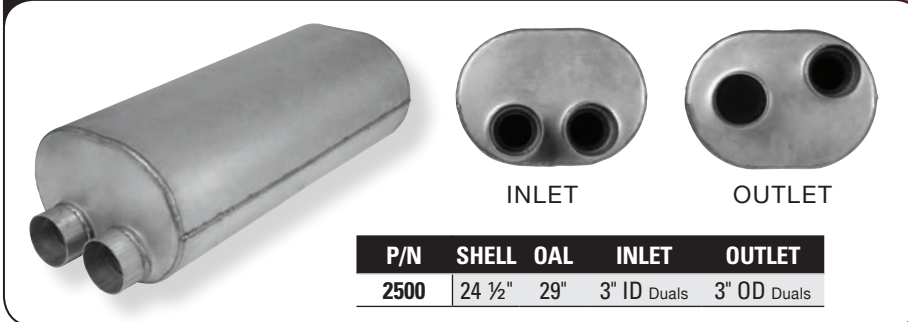

- Dual Outlets Fit OEM Tail Pipe
- Original Equipment Tuning for OE Sound

SINGLE OUTLET PERFORMANCE OPTION (8 1/2" x 11 3/4")



- Use with Xlerator Mandrel Bent Pipe X6007 or MaxFit Pipe 126584
- Performance Sound on Single Outlet 3" Tailpipe
- Recommended Optional Stainless Tip ST1079

DUAL OUTLET PERFORMANCE OPTION (8 1/2" x 11 3/4")



- Full Performance Sound when used with Xlerator Mandrel Bent Pipe No.'s X6013 (LS) and X6014 (RS) or Use MaxFit Pipes 127670 (LS) and 127671 (RS)

- Recommended Optional Stainless Tip numbers:

Slant Cut: ST1023
 Slant Rolled: ST1073
 Straight Rolled: ST1166

PERFORMANCE FEATURES

- All welded construction
- High flow design
- Better performance
- Heavy gauge 100% aluminized steel
- Increase flow
- Excellent performance sound

POPULAR OPTIONS FOR DUALING PICKUP TRUCKS

Mandrel Bent Pipes are available.

CHEVY/GMC, DODGE, FORD

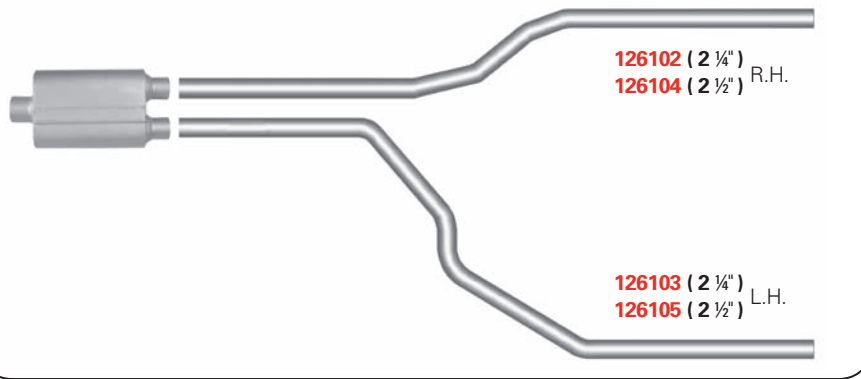

P/N	INLET	OUTLET	BRAND
XS1149	2 1/4"	2 1/4" Duals	XLERATOR
XS2157	2 1/2"	2 1/4" Duals	XLERATOR
XS2158	2 1/2"	2 1/2" Duals	XLERATOR
XS2198	3"	2 1/2" Duals	XLERATOR
VX0422	3"	2 1/4" Duals	VX
VX4422	2 1/4"	2 1/4" Duals	VX
VX5400	2 1/2"	2 1/2" Duals	VX
VX5422	2 1/2"	2 1/4" Duals	VX
690513	2 1/2"	2 1/4" Duals	TURBO
690514	2 1/2"	2 1/2" Duals	TURBO
690510	3"	2 1/4" Duals	TURBO
690511	3"	2 1/2" Duals	TURBO

CHEVY/GMC, DODGE, FORD

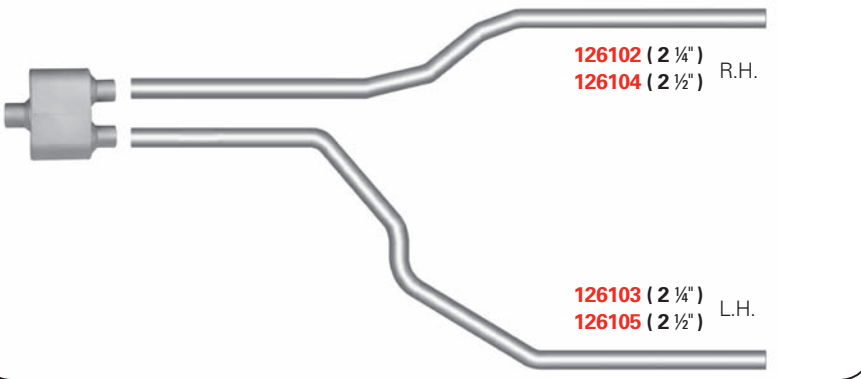

P/N	INLET	OUTLET	BRAND
VR7425	2 1/2"	2 1/4" Duals	VR
VR7427	3"	2 1/2" Duals	VR



© 2010 AP Exhaust Products, Inc.

All Rights Reserved

300 Dixie Trail
Goldsboro, NC 27530
P. 919.580.2000
F. 919.580.2010

www.apexhaust.com

Printed in USA